

BACK TO BACK C-SECTION GIRDERS (AS INDICATED BY DOUBLE LINES BETWEEN COLUMNS)

1. ORIENTATE C-SECTIONS WITH PIECE MARK SO THAT IT FACES UP ON THE TOP LEFT SIDE. (TO LOOK AT A C-SECTION CORRECTLY, THIS SIDE IS THE FRONT SIDE. → [)

2. BOLT INTERIOR C-SECTION GIRDERS TOGETHER "BACK TO BACK" AS SHOWN BELOW. THIS TYPE OF FRAMING CONDITION IS REPRESENTED BY A DOUBLE LINE BETWEEN TWO COLUMNS AS SHOWN ON PLAN DRAWINGS. SEE EXAMPLE ABOVE. WHEN ORIENTATING THE PIECE MARKS IN THEIR CORRECT LOCATIONS, ALL HOLES IN "BACK TO BACK" MATING C-SECTIONS WILL LINE UP.

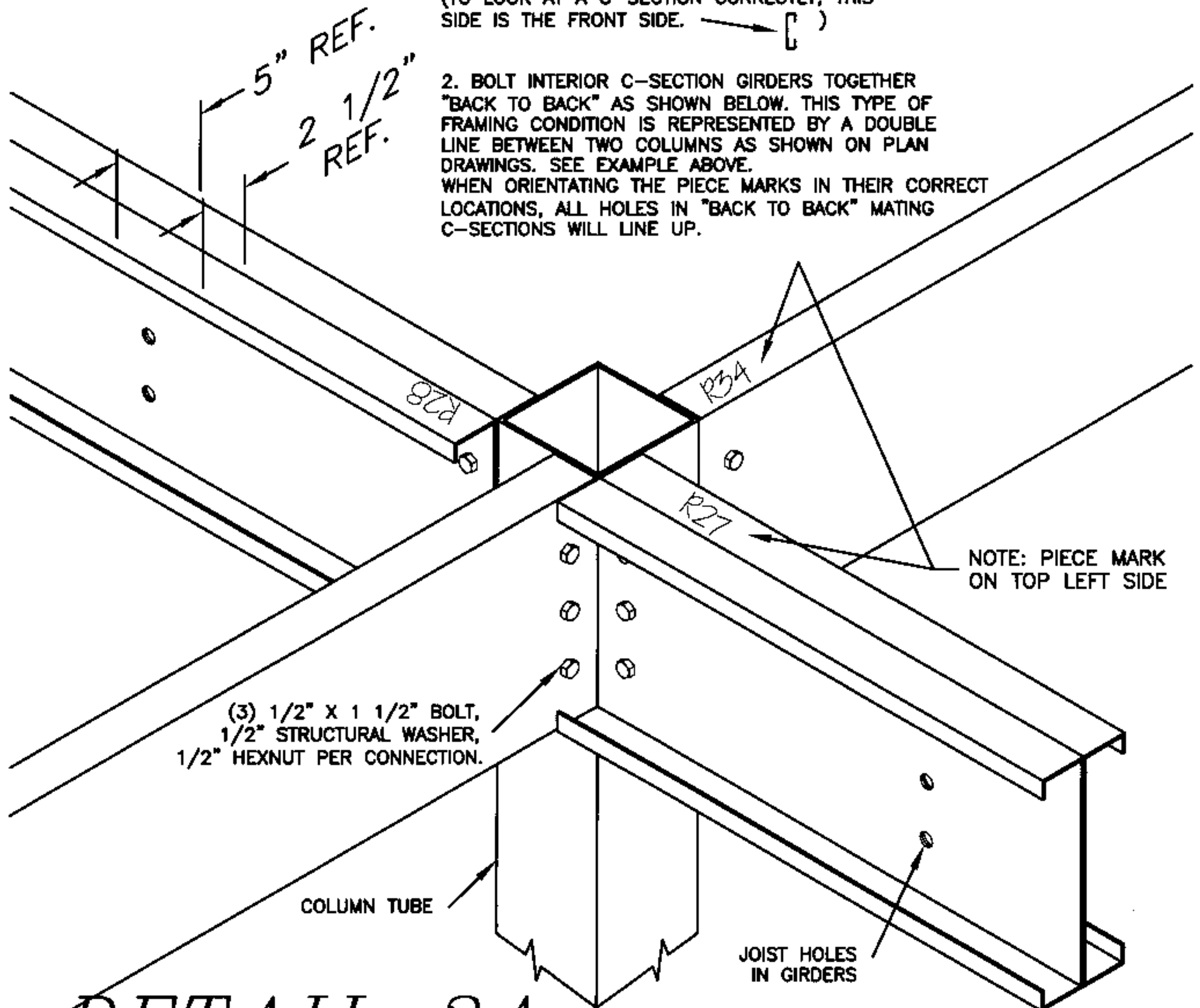

DETAIL 2A

BACK TO BACK C-SECTION GIRDER DETAIL